

Independence™**SEALED RECHARGEABLE LEAD-ACID****B A T T E R I E S**

YUASA
NP7-12
NP7-12FR

12V, 7.0Ah**Specifications****NOMINAL VOLTAGE:** 12V**NOMINAL CAPACITY:**

20 hr. rate of 0.35A to 10.50V 7.0Ah
10 hr. rate of 0.65A to 10.50V 6.5Ah
15 hr. rate of 1.19A to 10.20V 5.95Ah
1 hr. rate of 4.20A to 9.60V 4.2Ah

WEIGHT (approx.) 6.17 pounds (2.64 kgs.)**ENERGY DENSITY (20 hr. rate):**

1.49 WH/cubic inch (91.0 WH/liter)

SPECIFIC ENERGY (20 hr. rate):

13.6 WH/pound (30 WH/kg)

INTERNAL RESISTANCE OF CHARGED BATTERY:

30 milliohms (approx.)

MAXIMUM DISCHARGE CURRENT**WITH STANDARD TERMINALS:**

40 amperes

MAXIMUM SHORT-DURATION**DISCHARGE CURRENT:**

210 amperes

OPERATING TEMPERATURE RANGE:**CHARGE** 5°F to 122°F

(-15°C to 50°C)

DISCHARGE -4°F to 140°F

(-20°C to 60°C)

CHARGE RETENTION (shelf life) at 68°F (20°C):**1 month** 97%**3 months** 91%**6 months** 85%**LIFE EXPECTANCY:****STANDBY USE** 3 to 5 years**CYCLE USE (approx.)****100% depth of discharge** 250 cycles**50% depth of discharge** 550 cycles**30% depth of discharge** 1200 cycles**SEALED CONSTRUCTION:**

Can be operated in any position without leakage.

STANDARD TERMINAL:

Quick Disconnect .187 or Optional .250

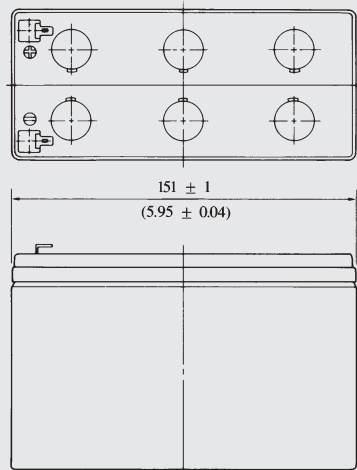
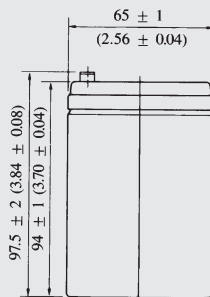
HOUSING MATERIAL: ABS Resin**OPTIONAL:** Container and cover made from Flame Retardant ABS (UL94-VO/L.O.I.>28%)**Dimensions**

DIMENSIONS: MM (INCHES)

Terminal

Available with .250 option

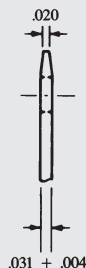
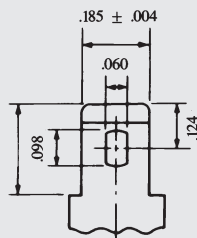
**INCH = MM**

.250 6.35

.185 4.70

.124 3.15

.098 2.49

.060 1.52

.031 0.79

.020 0.51

.004 0.10

DIMENSIONS: (INCHES)



RECOGNIZED BY UL, File No. MH 16464

DISCHARGE CHARACTERISTIC CURVES

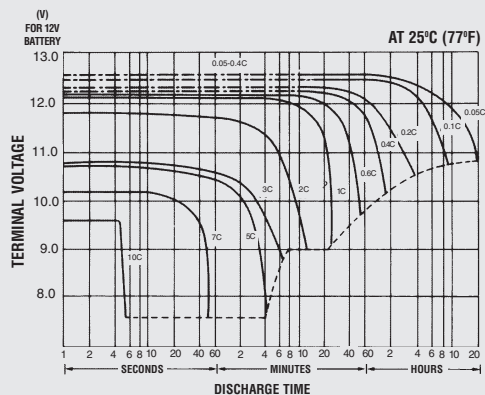

TEMPERATURE EFFECTS IN RELATION TO BATTERY CAPACITY

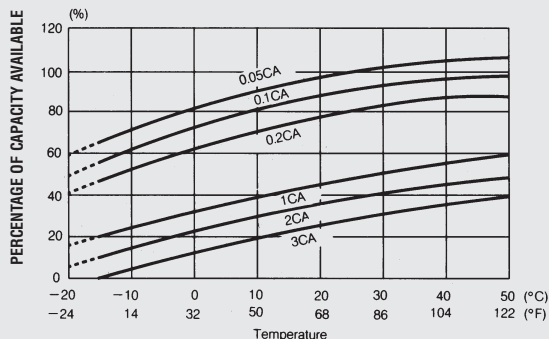

SELF DISCHARGE CHARACTERISTICS

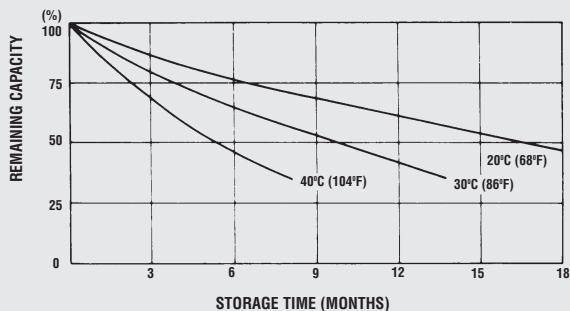

OPEN CIRCUIT VOLTAGE VS REMAINING CAPACITY

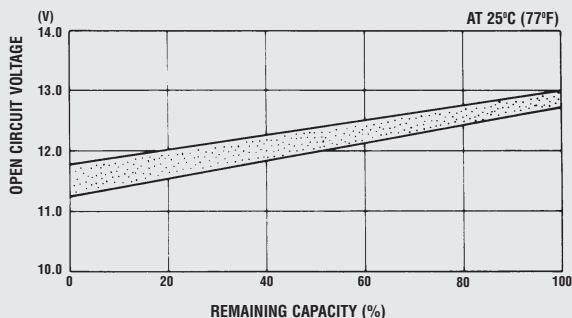

CYCLE SERVICE LIFE IN RELATION TO DEPTH OF DISCHARGE

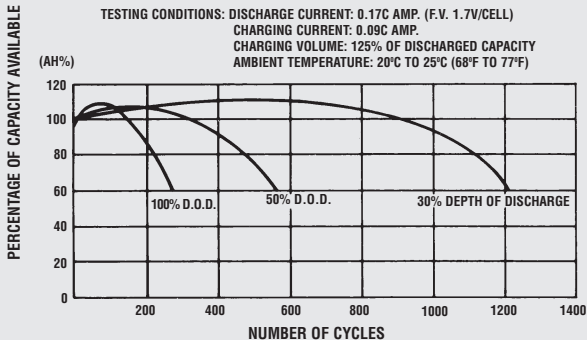

FLOAT SERVICE LIFE

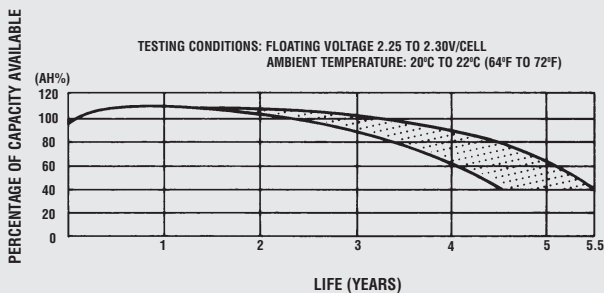

When the battery will be used by the current in excess of 3C, consult with EnerSys, Inc. prior to use.

CHARGING METHODS (At 20°C) **Cycle use:** Maximum charging current 1.75A
 Charging voltage 14.4 to 15.0V
Standby use: Float charging voltage 13.50 to 13.80V

CAUTION

- Avoid short circuit
- Do not charge in a sealed container.

Represented by:

When ordering new batteries, also remember to properly recycle your old lead batteries. Federal and state regulations require lead-acid batteries be recycled. EnerSys' nationwide service organization can arrange pickup, transportation to and recycling at any one of our company affiliated smelters. Call 1-800-972-7372 for more information.



Sales Offices

Eastern Region: 201-964-0118 • 1-800-962-1287
 FAX 201-964-0720
Western Region: 562-949-4266 • 1-800-423-4667
 FAX 562-949-5527
Corporate Office: P.O. Box 14145, Reading, PA 19612-4145
 FAX 610-372-8613
 Visit us on the web at: www.enersysstationary.com